



Guía de Inicio Rápido

Quick Start Guide



Unpack  
Abra o detector

Desempaquete el detector

Insert Batteries  
Coloque as baterías

Inserte las baterías

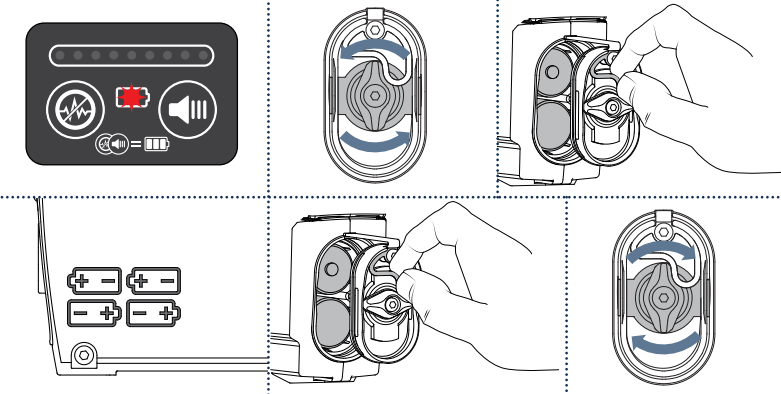
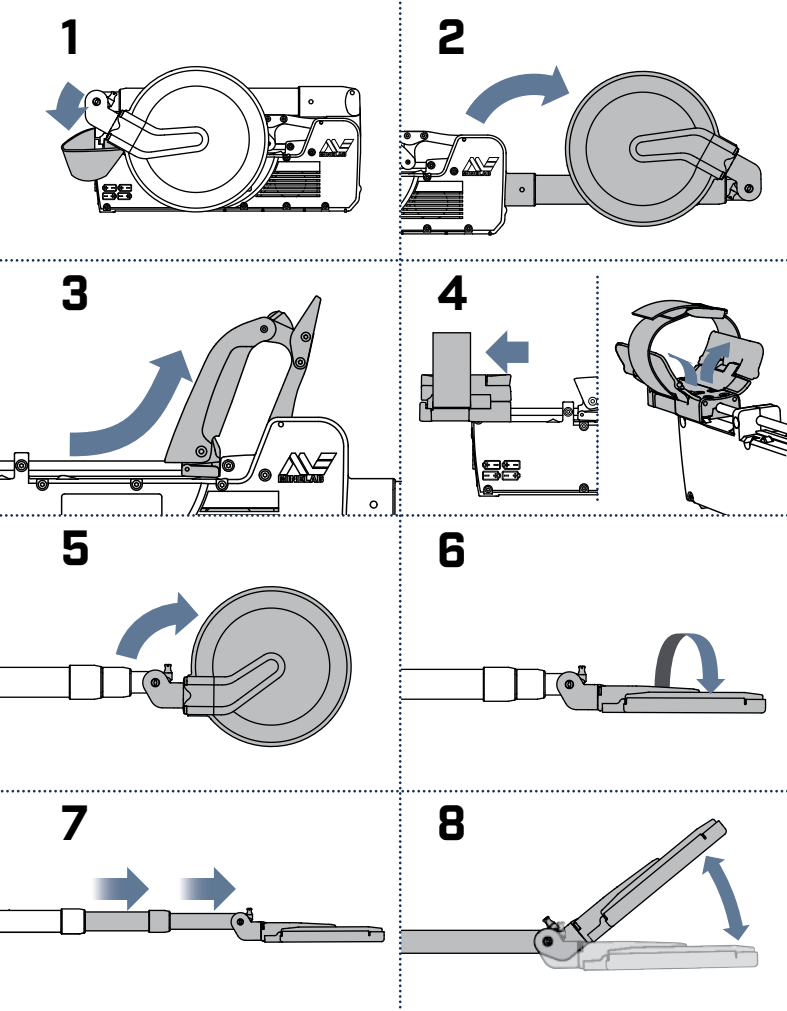

Connect Headphones  
Conecte os fones de ouvido

Conecte los auriculares

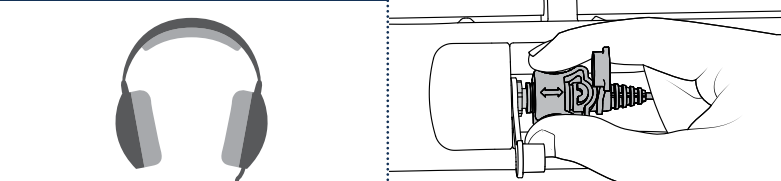

Pack Up  
Fecher o detector

Empaquete el detector

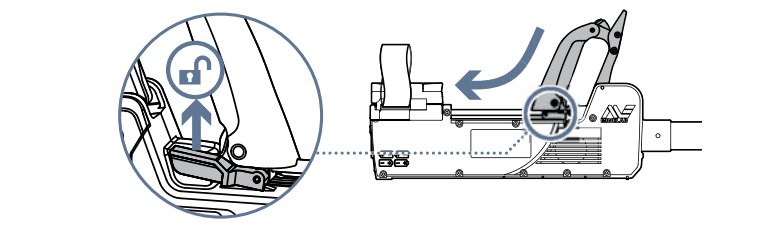

OPERATING FREQUENCY: The detector is configured to operate at a fundamental operating frequency of 9.3 KHz.

Read the instruction manual for more detailed information  
Lea el manual de instrucciones para obtener información más detallada  
Leia o manual de instruções para informações mais detalhadas



www.minelab.com

## Setup

## Configuraciones

## Ajustes

### 1

Set default Sensitivity  
 Ajustar la sensibilidad estándar  
 Ajustar à Sensibilidade padrão

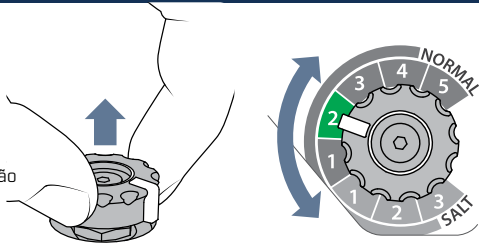

### 2

Turn On  
 Encender el detector  
 Ligar o Detector

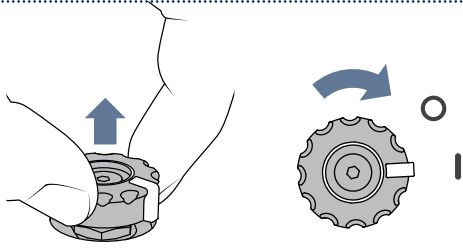

### 3

Noise Cancel  
 Cancelar el Ruido  
 Cancelar Ruído

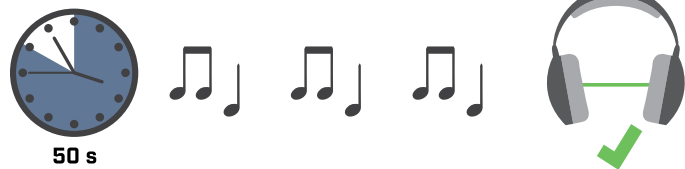

### 4

Set Threshold  
 Ajustar el umbral  
 Ajustar o Tom Limiar



### 5

Ground Balance  
 Realizar el Balance de Tierra  
 Realizar o Equilíbrio de Solo

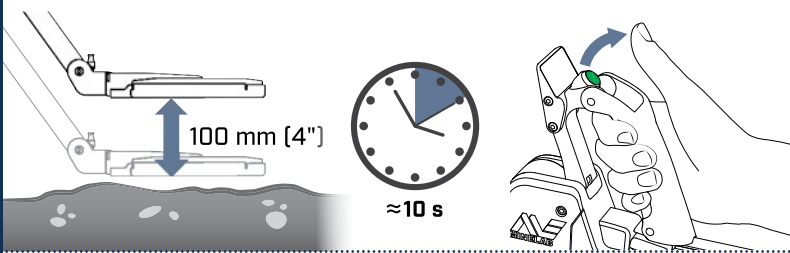
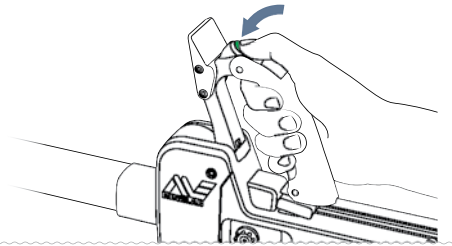

### 6

Start Detecting  
 Empezar la Detección  
 Começar a Deteção

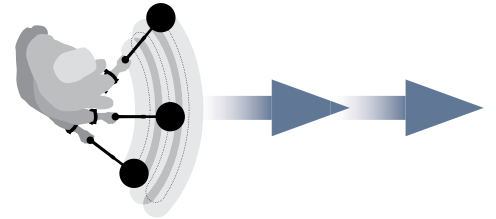

## Detecting Basics

## Detección Básica

## Detecção Básica

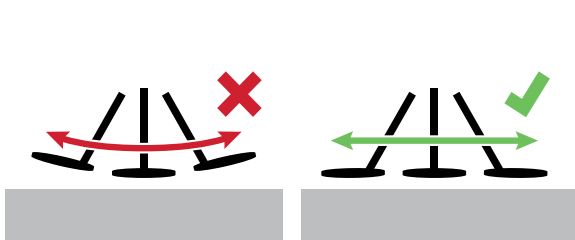

Sweep level  
 Nivel del barrido  
 Nível da varredura

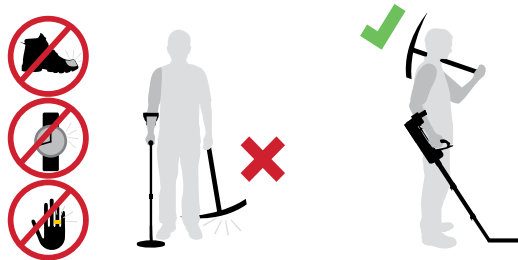

Keep metal away from coil  
 Mantenga los metales lejos de la bobina  
 Mantenha metais afastados da bobina

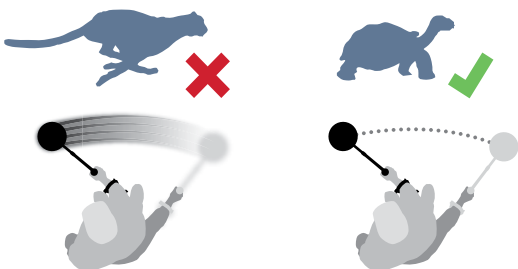

Sweep slowly  
 Barra lentamente  
 Varra lentamente

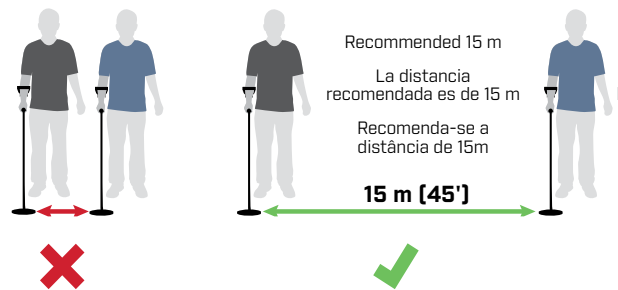

Recommended 15 m  
 La distancia recomendada es de 15 m  
 Recomenda-se a distância de 15m

Move apart  
 Manténgase lejos de otros detectores  
 Afaste-se de outros detectores



Overlap sweep  
 Superposición del barrido  
 Sobreponha a varredura



Refill hole  
 Vuelva a llenar el agujero  
 Tape o buraco